



Source 2s

EN Installation & Setup Guide



Table of Contents

Table of Contents	3
Introduction	4
Product overview	5
Before installation	5
Installation	7
Installing the App	8
Installing the mounting plate	9
Mounting the Source 2s	10
Connecting the cables	11
Configure the product	13
Finalise the installation	14
Product interface	15



Introduction

Before installing the product, read the important product and safety guide at volttime.com/manuals. Here you can also find other versions and languages.

This installation and setup guide includes:

- Mounting and wiring up Source 2s
- Configure the product
- LED status description

To install and configure a Source 2s, a mobile device with an internet connection is required as well as an internet source connected to the charger (Ethernet, WiFi or an optional 4G LTE connection).

WARNINGS AND CAUTIONS



Whenever a condition, hazard or unsafe practice can result in serious personal injury or death, a **WARNING** will be indicated.



WARNING: Volt Time stipulates that the installation as well as all maintenance or reparation on this product must be performed by a certified electrician. All applicable local, regional and national regulations for electrical installations must be followed.



Product overview

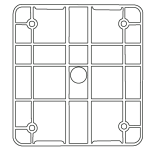
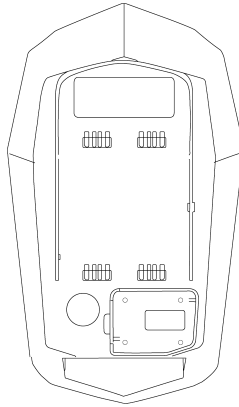
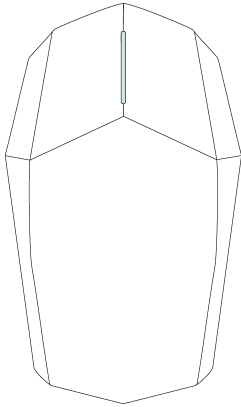

1x

Mounting Plate + Drill Hole Diagram

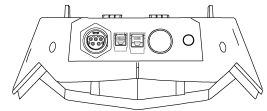

Front

LED indicator and RFID sensor on the front of the casing.

Back

Contains all the electronics internally to charge your vehicle, with easy mounting options on the back.

Connectivity

With three connectivity ports at the bottom, the installation is made completely plug-and-play.

Parts:



4x

PZ2 M5x50 Screw



1x

H3 M4x20 Bolt



4x

MBX60 Wall Plug



1x

H3 Hex Key



1x

RFID Card



2x

R045 Connector



1x

AC Mains



1x

R045 Sleeve



1x

R045 Plug



Before installation

The following prerequisites are mandatory to fully commission the product:

- A mobile device with internet connection.
- Volt Time “Installer App” on a mobile device.
- The product with an internet connection.
 - ! Without the Business Upgrade the product **requires** a CAT5(e) ethernet cable or WiFi connection for internet.
- Upstream Circuit Breaker and RCD Type A (30mA).
- If Load Management is desired, any charger **requires** a CAT5(e) ethernet cable or WiFi connection to work with our selected Wireless Load Management modules.

Optimal charging

For an optimal charging experience the following is recommended:

- To avoid overloading the main fuses of the building, one of our selected Wireless Load Management modules is recommended. These modules will dynamically adjust the maximum current of the product and provide the option to charge fully on surplus Solar Energy.
- A 3-phase installation of the product is recommended if possible.
- Always use the largest available cable cross-section. Installation with the AC Mains connector can go up to 6mm² cable cross-section.



CAUTION: The grid type as well as cable-cross sections should be determined by the electrician before installing the product.



Installation

WARNING: Prior to the installation of the product, the power supply must be switched off. Make sure to follow this manual closely and with extreme caution.

The instructions and procedures discussed in this manual must be followed and applied at all times, or it will result in an invalidated installation. This will cause Volt Time B.V. and its partners to waive all liability and claims for compensation.

Installations and maintenance on this product must only be performed by qualified and authorised personnel. Any technical support or repairs on the product must be executed by Volt Time or a pre-approved Volt Time certified company.

All applicable local, regional and national laws and regulations must be adhered to at all times.

Do **not** install or use the product in case of damage as it can lead to unsafe or hazardous conditions which may result in electrical shock or (potentially fatal) injury.

Avoid placing the product in a location exposed to direct sunlight or extreme weather/temperature conditions.





Installing the App

1. Scan the QR code to download the Volt Time Installer App and create a free account.
2. Log in with your (newly created) Installer account.
3. Enter the serial number and unique pincode found on the sticker at the bottom of the product.
4. Check the installation requirements via the installer app and return to this guide afterwards.



Warning: It is not possible to commission a Source 2s charger without using the installer app. The charger will remain “unconfigured” and unusable until you use the app.



Or go to <https://volttime.com/installer> to install the Volt Time Installer App to your mobile device.



Installing the mounting plate

1. Hold the mounting plate drawing against the wall and make sure it is level.
2. Recommended installation height is 120cm. Minimum installation height is 90cm.
3. The drawing has 4 screw locations. Drill these 4 holes with an 8mm drill bit.
4. Push M8 wall plugs (4x) into the drilled holes.
5. Place the mounting plate with the flat edge against the wall and the slits of the mounting plate pointing up- and downwards.
6. Screw the mounting plate against the wall using PZ2 screws (4x).

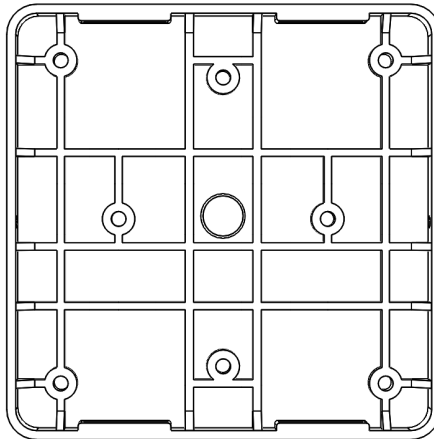

CAUTION: The installation wall must cover the entire backplate and should be perfectly flat. If not flat, use rubber rings behind every screw hole to create a flat surface.



Mounting the Source 2s

1. Push the product over the mounting plate so that the mounting hooks fit into the 4 slits of the plate.
2. Slide the product downwards until it snaps in place.
3. Fasten the product onto the mounting plate by screwing the H3 bolt (1x) into the hole on the left side of the product using the H3 Hex allen key.

Optional

4. To install the product with the AC mains wires fed through the wall as well as using the AC Mains Connector, drill a hole 12cm under the tip of the AC Mains port (4). See drill hole diagram.

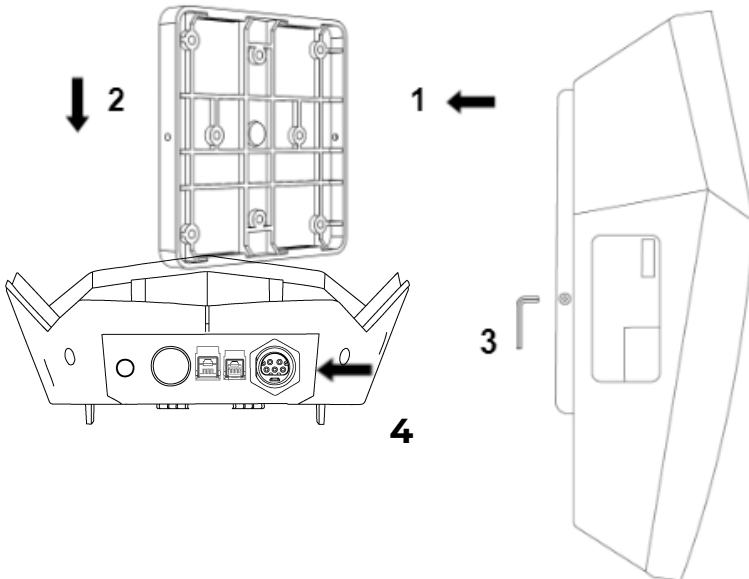



Connecting the cables

Power cable

1. Push the cable gland over the cable.
2. Place the right seal into the housing.
3. Push the housing with the seal over the cable.
4. Strip 50mm off the sheath.
5. Shorten the wires N, L1, L2 and L3 by 8mm.
6. Strip 12mm off the wires.
7. You can use stranded or solid cores. For stranded cores make sure to use ferrules accordingly.
8. Connect the wires to the contact carrier:

Earthing System	Power Connection Volt Time Source 2				
		N	1	2	3
TN/TT (230V)	PE	N	L1		
TN/TT (400V)	PE	N	L1	L2	L3
IT (230V)	PE	L1	L2		

9. Torque the screws to 1Nm on the contact carrier.
10. Push the contact carrier into the housing until it snaps in place audibly.
11. Tighten the cable gland to a torque of 4.5Nm.
12. Click Volt Time AC Mains Connector into the power connector at the bottom with the clip pointing towards the wall/pole.

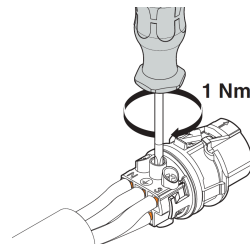
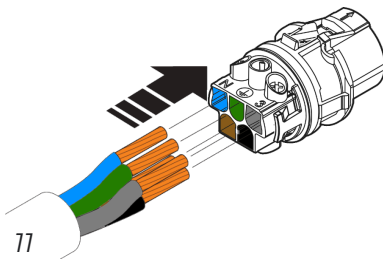
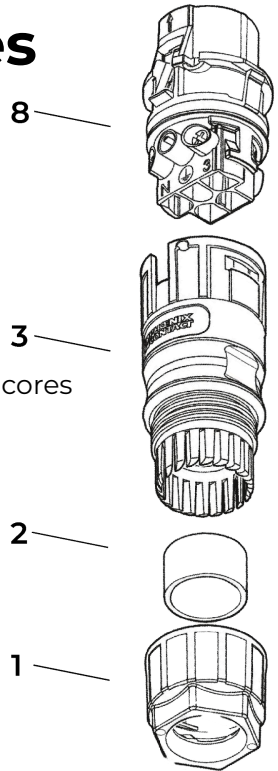



Ethernet connection

1. Use a CAT5(e) ethernet cable with a maximum length of 100m. Source 2s (without business upgrade) **requires** an ethernet cable or WiFi with internet connection to function. For Power Sharing functionality, an ethernet cable or WiFi connection is **always** required.



2. Push the grey sleeve with the tip first onto the CAT5(e) cable at the product side and turn it inside out (as indicated below).
3. Strip 12.5mm from the outer coating on each end of the cable.
4. Crimp the RJ45 connectors onto both ends of the CAT5(e) cable.
5. Test the ethernet cable using a LAN Cable Tester.
6. Connect the ethernet cable to the Router/Switch inside the building as well as the RJ45 port on the bottom of the product **(2)**.
7. Pull the sleeve back into its normal position and push it over the RJ45 port at the bottom of the product until it seals the port fully.
8. If no ethernet cable is used during the installation, place the RJ45 protection cover inside the RJ45 port at the bottom of the charger.

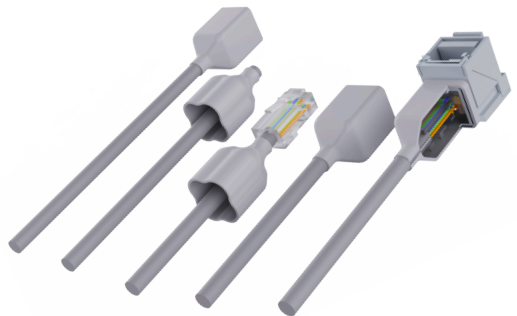
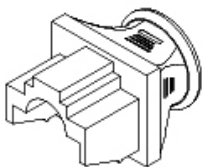
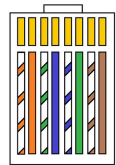



Configure the product

1. Turn on the power supply by switching on the Circuit Breaker inside the distribution box. The LED should change to green after a maximum of 1 minute.
2. After connection to our Cloud the charger will go straight to a blinking red LED awaiting configuration via the app.
3. Open the Volt Time “Installer App”.
4. Enter the serial number and pincode of the product, found on the pincode sticker at the bottom of the product.
5. Tap “Configure manually”.
6. Select one of the two site setups in the App:

Create new site

If the product is installed at a completely new installation site, click on “No, just this one” and follow the on-screen instructions to configure the product.

Add to existing site

If the product is installed at a site with existing Volt Time chargers, click on “Yes” and follow the on-screen instructions to configure the new product.

7. After the configuration of the newly installed product the LED should be green. Return to this manual.



Finalise the installation

1. Start a test session by plugging the charging cable into the car.

Note:

- A Source 2s fixed cable variant can be connected to the car by plugging the charging cable into the charging port of the car.
 - A Source 2s socket variant can be connected to the car by plugging the male end of the charging cable into the socket of the product and the female end of the charging cable into the charging port of the car.
 - The RFID card should first be added via the User App (Volt Time) before starting a session.
2. The LED will indicate a successful charging status by showing a dark blue colour during the charging process.
 3. Provide the Source 2s owner with the pincode and user manual.



Well done. You are finished with the installation and configuration of Source 2s!

Insulation Test

After the installation of the product, insulation testing can be performed on the installation. During the test, the product has to be disconnected from the installation. If the product is still connected to the installation, the test results may fail or the electronics of the product may get damaged.



Product interface

Light/Sound description	Status of charging station
No LED - Makes sound 1x	Booting charger
Green - Constant	Standby, ready for use
Makes sound 1x	RFID card is scanned
Yellow - Constant	RFID card is authorised for the charging session or the car is connected to the charger.
Light blue - Constant	Waiting for the vehicle to initiate charging or the car is full.
Dark Blue - Constant	Charging in progress
Light blue - Blinking	Waiting for (Solar) power.
Red - Blinking	Charger is locked / unconfigured
Red - Constant	<p> WARNING Critical error. Check the Installer app for more information. Do not try to charge the vehicle.</p>

VOLT TIME

Meer en Duin 216 - 2163HD, Lisse
www.volttime.com

June 2024 - V2.0

Copyright 2024 Volt Time B.V.
Volt Time® is a Registered Trademark.



36430